



Adjacent Properties and Boundaries are shown for illustrative purposes only and have not been surveyed unless otherwise stated.  
 All areas shown are approximate and should be verified before forming the basis of a decision.  
 Do not make other than for Planning Application purposes.  
 All dimensions must be checked by the contractor before commencing work on site.  
 No deviation from this drawing will be permitted without the prior written consent of the Architect.  
 The copyright of this drawing remains with the Architect and may not be reproduced in any form without prior written consent.  
 Ground Plans, Sections, Foundations, Sub-Structures, etc. All work below ground level is shown provisionally. Inspection of ground conditions is essential prior to work commencing.  
 Responsibility is assumed when the ground conditions are apparent, and redesign may be necessary in the light of soil conditions found. The responsibility for establishing the soil and sub-soil conditions rests with the contractor.

Scale 1:500



**PLANNING DRAWINGS**

Rev.	Date	Description	Initials

PROJECT: Ravenswick Hall  
 Kirklymnoorside  
 TITLE: Existing Site Survey  
 SCALE: 1:500 @A1  
 DATE: 2015 September  
 DRAWING No: 5766/40  
 DRAWN BY: MJ

DATE VALID 09/10/15

**ADAM ARCHITECTURE**  
 OLD HYDE HOUSE, 75 HYDE STREET  
 WINCHESTER, HAMPSHIRE, SO23 7DW  
 TELEPHONE: 01962 443441 FACSIMILE: 01962 443443  
 www.adamarchitecture.com contact@adamarchitecture.com  
 LONDON OFFICE: 6 QUEEN SQUARE, WC1N 3AT  
 TELEPHONE: 020 7841 0140 FACSIMILE: 01962 443443  
 ADAM ARCHITECTURE IS A TRADEMARK OF ADAM ARCHITECTURE LIMITED



ADJACENT PROPERTIES AND BOUNDARIES ARE SHOWN FOR ILLUSTRATIVE PURPOSES ONLY AND HAVE NOT BEEN SURVEYED UNLESS OTHERWISE STATED.  
 ALL AREAS SHOWN ARE APPROXIMATE AND SHOULD BE VERIFIED BEFORE FORMING THE BASIS OF A DECISION.  
 DO NOT MAKE OTHER PLANS FOR PLANNING APPLICATION PURPOSES.  
 ALL DIMENSIONS MUST BE CHECKED BY THE CONTRACTOR BEFORE COMMENCING WORK ON SITE.  
 NO DEVIATION FROM THIS DRAWING WILL BE PERMITTED WITHOUT THE PRIOR WRITTEN CONSENT OF THE ARCHITECT.  
 THE COPYRIGHT OF THIS DRAWING REMAINS WITH THE ARCHITECT AND MAY NOT BE REPRODUCED IN ANY FORM WITHOUT PRIOR WRITTEN CONSENT.  
 GROUND FLOOR PLANS, FOUNDATIONS, SUB-STRUCTURES, ETC. ALL WORK BELOW GROUND LEVEL IS SHOWN PROVISIONALLY. INSPECTION OF GROUND CONDITIONS IS ESSENTIAL PRIOR TO WORK COMMENCING.  
 REASSESSMENT IS ESSENTIAL WHEN THE GROUND CONDITIONS ARE APPARENT, AND REDSIGN MAY BE NECESSARY IN THE LIGHT OF SOIL CONDITIONS FOUND. THE RESPONSIBILITY FOR ESTABLISHING THE SOIL AND SUB-SOIL CONDITIONS RESTS WITH THE CONTRACTOR.

Scale 1:500

Existing building - to be retained  
 Existing building - to be demolished

N  
 W O E  
 S

**PLANNING DRAWINGS**

No.	Date	Description	Initials
<b>PROJECT</b>			
		Ravenswick Hall Kirkcubynoiside	
<b>TITLE:</b>			
		Demolition Site Plan	
<b>SCALE:</b>			
		1:500 @A1	
<b>DATE:</b>			
		2015 September	
<b>DRAWING No:</b>			
		5766/41	
<b>DRAWN BY:</b>			
		BJ	

**ADAM ARCHITECTURE**  
 OLD HYDE HOUSE, 75 HYDE STREET  
 WINCHESTER, HAMPSHIRE, SO23 7DW  
 TELEPHONE: 01962 443441 FACSIMILE: 01962 443403  
 www.adamarchitecture.com contact@adamarchitecture.com

LONDON OFFICE: 6 QUEEN SQUARE, WC1N 3AT  
 TELEPHONE: 020 7841 0140 FACSIMILE: 01782 843163  
 ADAM ARCHITECTURE IS A TRADE MEMBER OF THE ROYAL INSTITUTE OF ARCHITECTS

DATE VALID  
 06/10/15

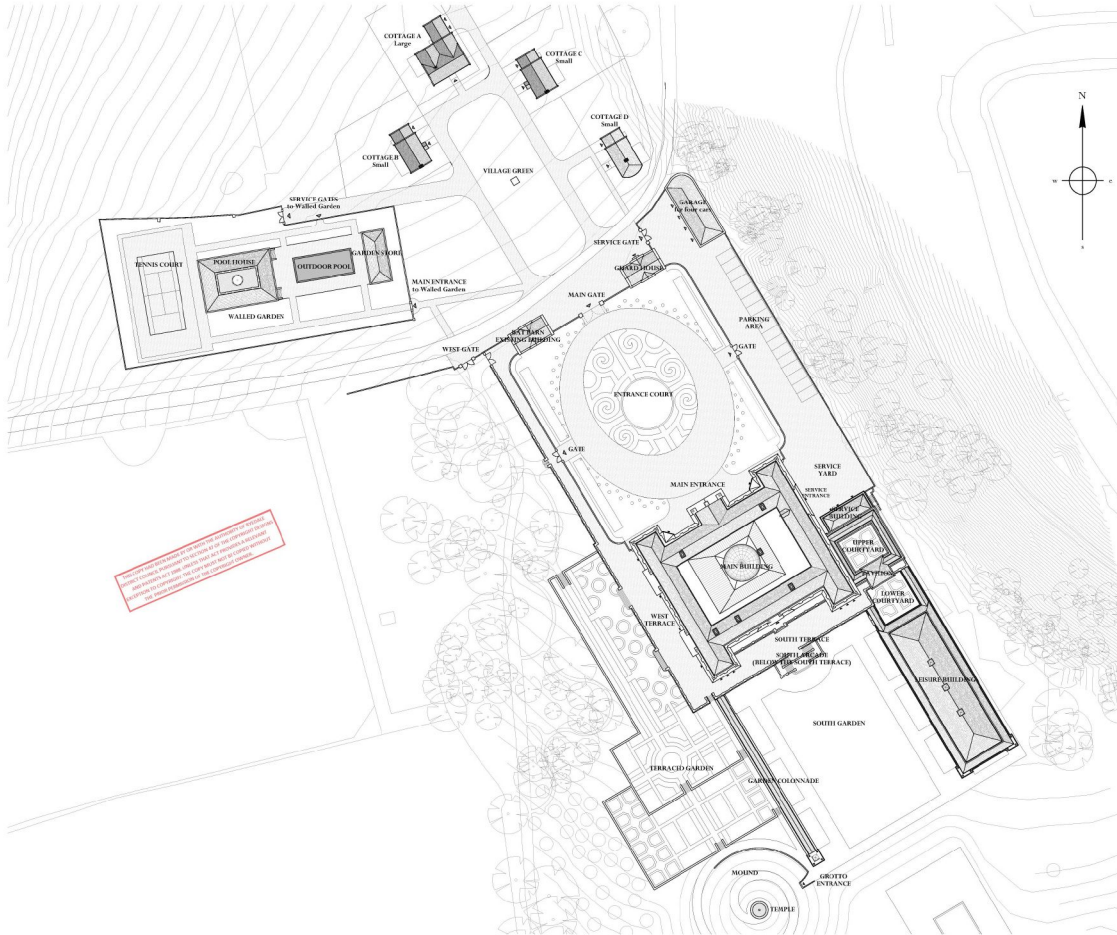

NOT TO BE USED FOR CONSTRUCTION WITHOUT THE WRITTEN APPROVAL OF ADAM ARCHITECTURE. ANY CHANGES TO THE DESIGN MUST BE APPROVED BY ADAM ARCHITECTURE. ANY UNAUTHORIZED CHANGES WILL BE AT THE USER'S RISK AND WITHOUT LIABILITY TO ADAM ARCHITECTURE.

Adjacent Properties and Boundaries are shown for illustrative purposes only and have not been surveyed unless otherwise stated.  
 All areas shown are approximate and should be verified before forming the basis of a decision.  
 Do not make other than for Planning Application purposes.  
 All dimensions must be checked by the contractor before commencing work on site.  
 No deviation from this drawing will be permitted without the prior written consent of the Architect.  
 The copyright of this drawing remains with the Architect and may not be reproduced in any form without prior written consent.  
 Ground Floor Plans, Foundations, Sub-Structures, etc. All work below ground level is shown provisionally. Inspection of ground conditions is essential prior to work commencing.  
 Reassessment is essential when the ground conditions are apparent, and redesign may be necessary in the light of soil conditions found. The responsibility for establishing the soil and sub-soil conditions rests with the contractor.



Scale 1:500

- Buildings within the drawing are:
- Main Building: 07 Main Building - Ground Floor 1:000(A1)
  - 08 Main Building - First Floor 1:000(A1)
  - 09 Main Building - North & South Elevations 1:000(A1)
  - 10 Main Building - West & East Elevations 1:000(A1)
  - 11 Main Building - Plan & Section 1:000(A1)
  - 12 Main Building - Section 1:000(A1)
  - 13 Main Building - Section 1:000(A1)
  - 14 Main Building - Section 1:000(A1)
  - 15 Main Building - Section 1:000(A1)
  - 16 Main Building - Section 1:000(A1)
  - 17 Main Building - Section 1:000(A1)
  - 18 Main Building - Section 1:000(A1)
  - 19 Main Building - Section 1:000(A1)
  - 20 Main Building - Section 1:000(A1)
  - 21 Main Building - Section 1:000(A1)
  - 22 Main Building - Section 1:000(A1)
  - 23 Main Building - Section 1:000(A1)
  - 24 Main Building - Section 1:000(A1)
  - 25 Main Building - Section 1:000(A1)
  - 26 Main Building - Section 1:000(A1)
  - 27 Main Building - Section 1:000(A1)
  - 28 Main Building - Section 1:000(A1)
  - 29 Main Building - Section 1:000(A1)
  - 30 Main Building - Section 1:000(A1)
  - 31 Main Building - Section 1:000(A1)
  - 32 Main Building - Section 1:000(A1)
  - 33 Main Building - Section 1:000(A1)
  - 34 Main Building - Section 1:000(A1)
  - 35 Main Building - Section 1:000(A1)
  - 36 Main Building - Section 1:000(A1)
  - 37 Main Building - Section 1:000(A1)
  - 38 Main Building - Section 1:000(A1)
  - 39 Main Building - Section 1:000(A1)
  - 40 Main Building - Section 1:000(A1)
  - 41 Main Building - Section 1:000(A1)
  - 42 Main Building - Section 1:000(A1)
  - 43 Main Building - Section 1:000(A1)
  - 44 Main Building - Section 1:000(A1)
  - 45 Main Building - Section 1:000(A1)
  - 46 Main Building - Section 1:000(A1)
  - 47 Main Building - Section 1:000(A1)
  - 48 Main Building - Section 1:000(A1)
  - 49 Main Building - Section 1:000(A1)
  - 50 Main Building - Section 1:000(A1)
  - 51 Main Building - Section 1:000(A1)
  - 52 Main Building - Section 1:000(A1)
  - 53 Main Building - Section 1:000(A1)
  - 54 Main Building - Section 1:000(A1)
  - 55 Main Building - Section 1:000(A1)
  - 56 Main Building - Section 1:000(A1)
  - 57 Main Building - Section 1:000(A1)
  - 58 Main Building - Section 1:000(A1)
  - 59 Main Building - Section 1:000(A1)
  - 60 Main Building - Section 1:000(A1)
  - 61 Main Building - Section 1:000(A1)
  - 62 Main Building - Section 1:000(A1)
  - 63 Main Building - Section 1:000(A1)
  - 64 Main Building - Section 1:000(A1)
  - 65 Main Building - Section 1:000(A1)
  - 66 Main Building - Section 1:000(A1)
  - 67 Main Building - Section 1:000(A1)
  - 68 Main Building - Section 1:000(A1)
  - 69 Main Building - Section 1:000(A1)
  - 70 Main Building - Section 1:000(A1)
  - 71 Main Building - Section 1:000(A1)
  - 72 Main Building - Section 1:000(A1)
  - 73 Main Building - Section 1:000(A1)
  - 74 Main Building - Section 1:000(A1)
  - 75 Main Building - Section 1:000(A1)
  - 76 Main Building - Section 1:000(A1)
  - 77 Main Building - Section 1:000(A1)
  - 78 Main Building - Section 1:000(A1)
  - 79 Main Building - Section 1:000(A1)
  - 80 Main Building - Section 1:000(A1)
  - 81 Main Building - Section 1:000(A1)
  - 82 Main Building - Section 1:000(A1)
  - 83 Main Building - Section 1:000(A1)
  - 84 Main Building - Section 1:000(A1)
  - 85 Main Building - Section 1:000(A1)
  - 86 Main Building - Section 1:000(A1)
  - 87 Main Building - Section 1:000(A1)
  - 88 Main Building - Section 1:000(A1)
  - 89 Main Building - Section 1:000(A1)
  - 90 Main Building - Section 1:000(A1)
  - 91 Main Building - Section 1:000(A1)
  - 92 Main Building - Section 1:000(A1)
  - 93 Main Building - Section 1:000(A1)
  - 94 Main Building - Section 1:000(A1)
  - 95 Main Building - Section 1:000(A1)
  - 96 Main Building - Section 1:000(A1)
  - 97 Main Building - Section 1:000(A1)
  - 98 Main Building - Section 1:000(A1)
  - 99 Main Building - Section 1:000(A1)
  - 100 Main Building - Section 1:000(A1)

**PLANNING DRAWINGS**

Doc. No.	Date	Description	Status
PROJECT		Ravenwick Hall Kirkhymoorside	
TITLE:		Site Plan	
SCALE:		1:500 @A1	
DATE:		2015 September	
DRAWING No:		5766/01	
DRAWN BY:		RJ	

DATE VALID  
09/10/15

**ADAM ARCHITECTURE**  
 OLD HYDE HOUSE, 75 HYDE STREET  
 WINCHESTER, HAMPSHIRE, SO23 7DQ  
 TELEPHONE: 01962 343841 FACSIMILE: 01962 343843  
 www.adamarchitecture.com contact@adamarchitecture.com  
 LONDON OFFICE: 6 QUEEN SQUARE, WC1N 3AT  
 TELEPHONE: 020 7841 0149 FACSIMILE: 01782 843163  
 ADAM ARCHITECTURE IS A TRADESMAN OF THE ROYAL ASSOCIATION OF ARCHITECTS